

Arrim ONE USER MANUAL (Android)

Quick Start

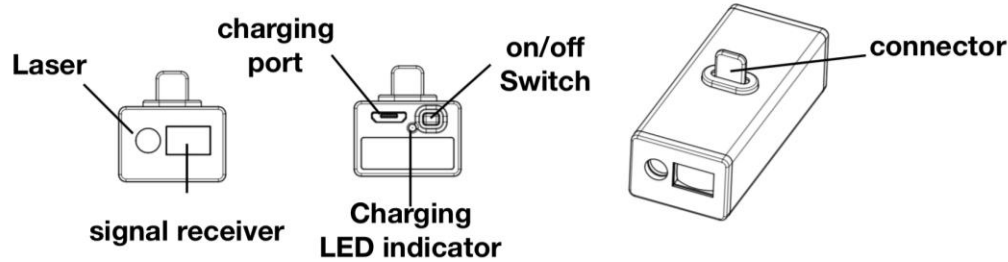

Turn on / off Arrim ONE

Press on/off Switch to turn on Arrim ONE

Press on/off Switch for 3 seconds to turn off Arrim ONE. And it will be automatically shut off in 3 minutes after last measurement.

Charging

Use the Micro-USB charging cable in the package to charge Arrim ONE. When it is charging, blue LED is on.

It takes one hour to fully charge Arrim ONE. You can check the battery status in Arrim ONE app. Arrim ONE has over-charge protection, so it will not be damaged if it is charged for longer.

Laser Status

OFF	No light. Arrim ONE is off.
Rest	Dim light. Arrim ONE is turned on, but not connected to mobile device via Bluetooth
Activated	Bright Red. Arrim ONE is turned on and connected, ready to go.

1. Download Arrim ONE app to your mobile device.

- Please search Arrim ONE on Google Play Store, and download it.

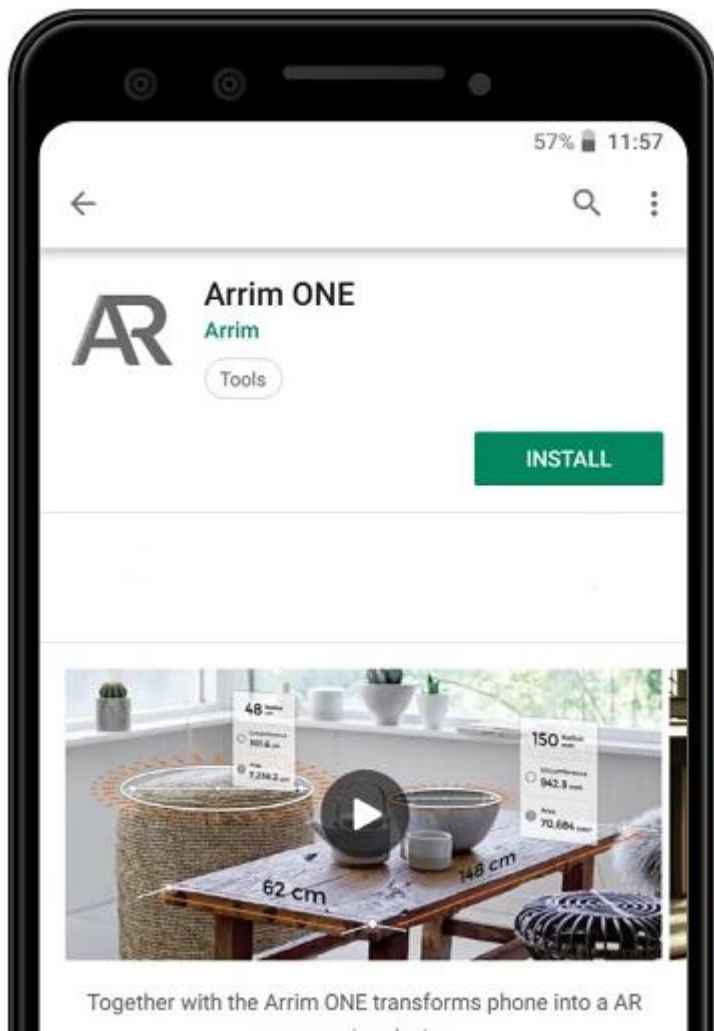

Arrim ONE supports 60+ mainstream Android devices. Please check the entire compatible list in Appendix.

2. Attach Arrim ONE with Mobile Device

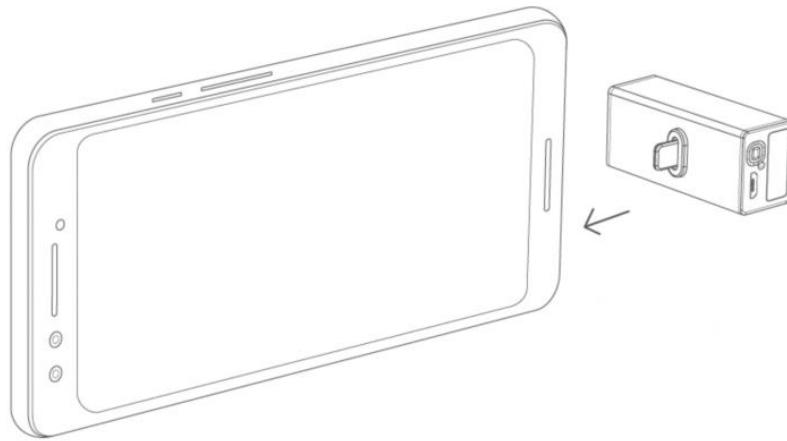

- Insert Arrim ONE to the mobile device. Laser is facing out.

If your phone case is too thick to fit Arrim ONE, you can use an adapter as the extension. The adapter is available on www.Arrim.net

⚠ Remember to turn on the adapter option in the Function & Setting.



3. Open Arrim ONE App

- Arrim ONE connects the mobile device via Bluetooth, so please make sure your mobile device's Bluetooth is turned on. You can go to **Setting / Connected devices / Bluetooth** to turn it on.
- Open Arrim ONE app. When you first time open Arrim ONE, it will ask permission to access the Camera & Bluetooth. Please click "Allow"

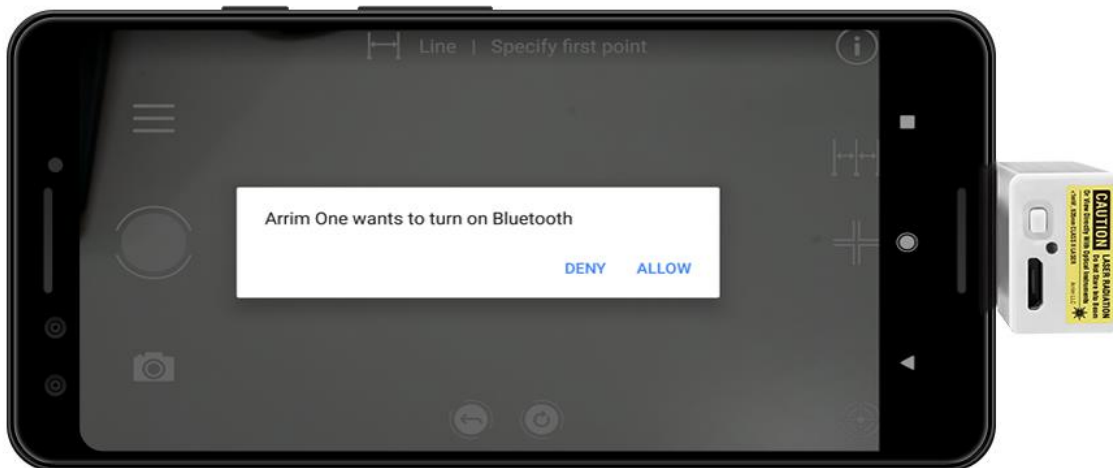
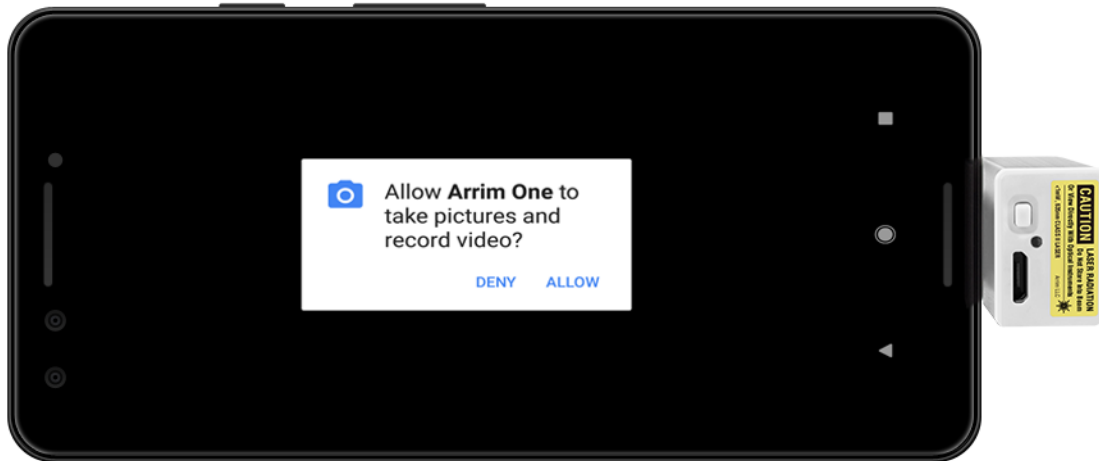

- Software starts to detect the environment, please move the device around slowly until the animation disappears.

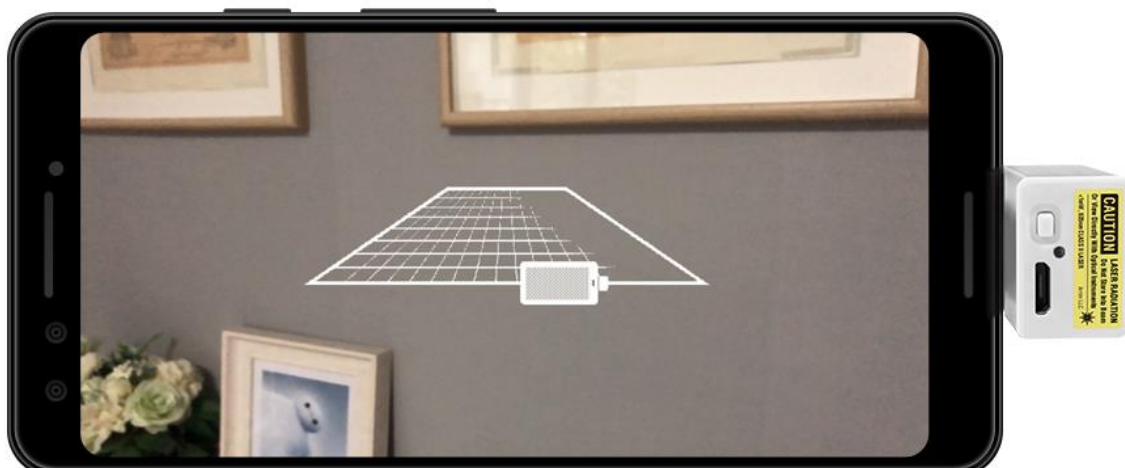

- Press on/off switch on the rear end to turn on Arrim ONE.

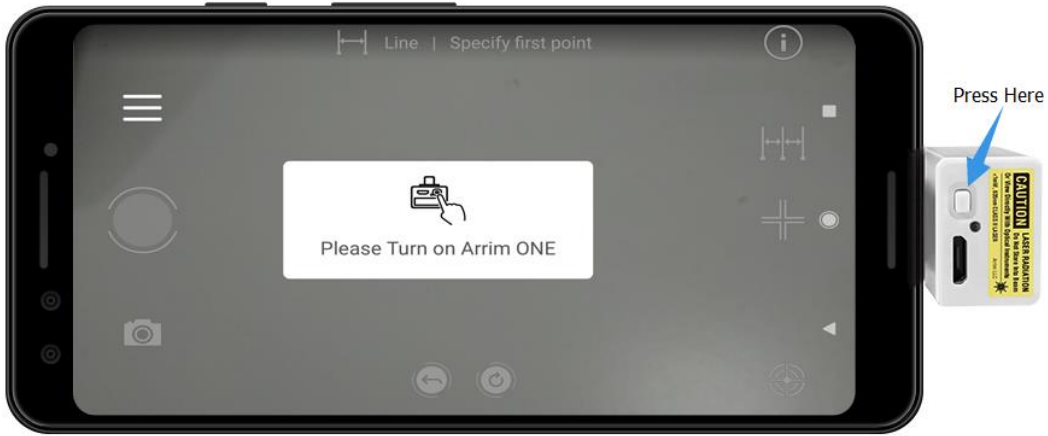

- Arrim ONE will be connected automatically with the mobile device via Bluetooth. The laser will be on, and you can see a bright red laser dot.

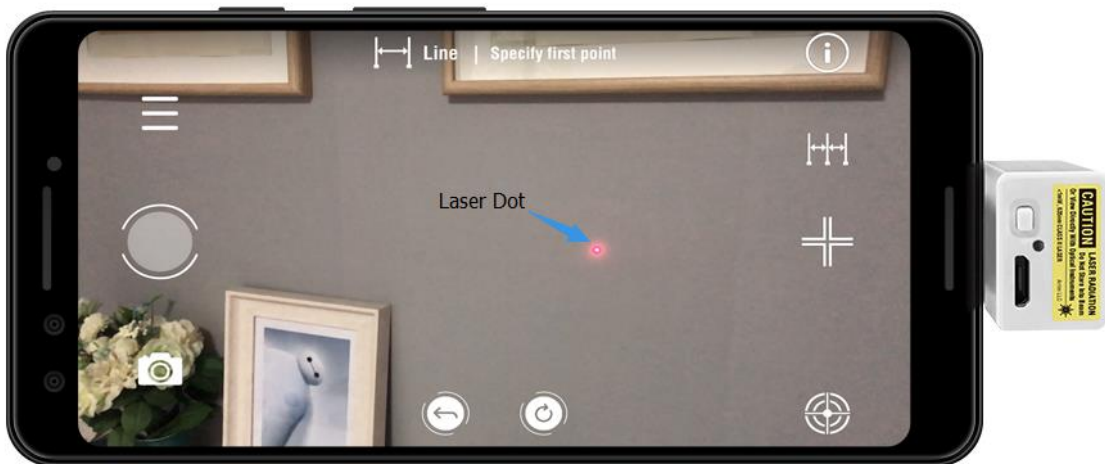

4. Calibration

- To achieve better accuracy, Arrim ONE requires a calibration before measuring. Just aim the laser to a wall / floor, and make sure the distance between Arrim ONE and wall / floor is between 2 ft - 9 ft (0.5 m - 3 m), and tap the calibration button on the right bottom

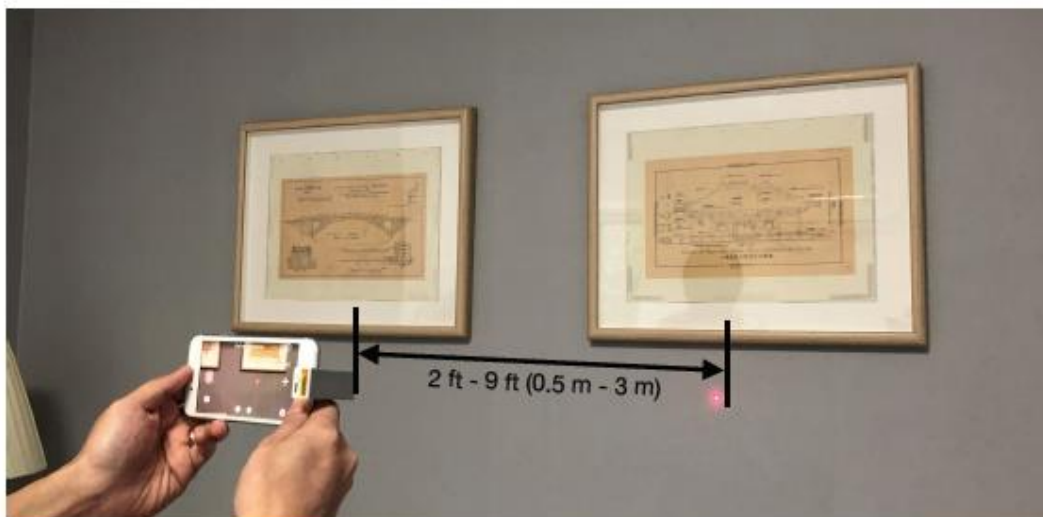

- Calibration completed. And it is ready to go!

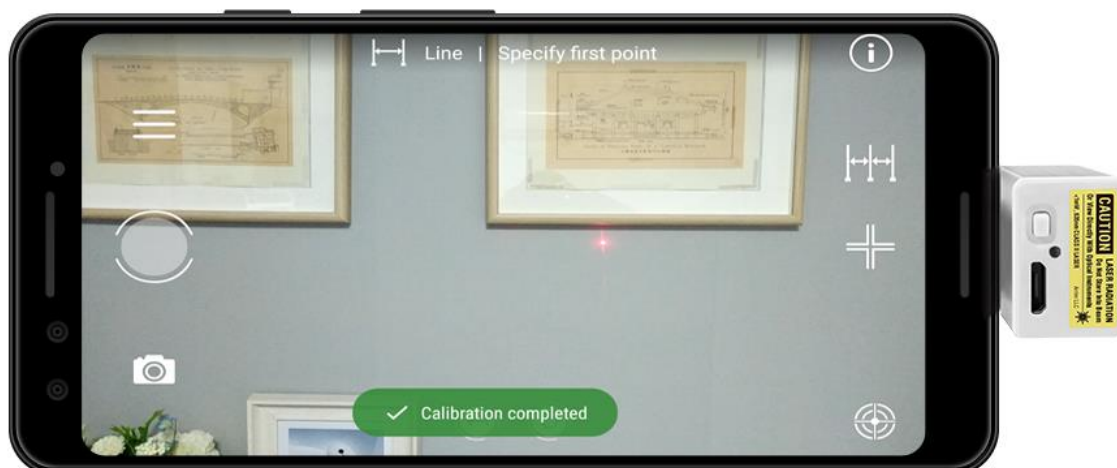

5. User Interface

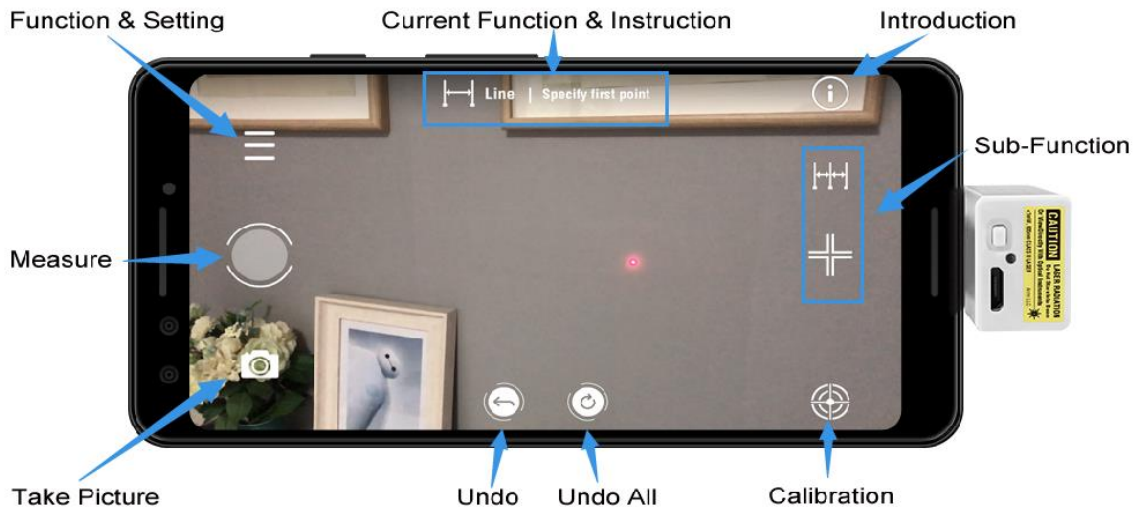

Function & Setting	Tap to enter Function & Setting, you can select different functions, set unit system/format and check the Arrim ONE battery status
Measure	Tap to define a virtual point, which is at the same location of laser dot in real world.
Take Picture	Snapshot the screen. The saved picture can be found in <u>Function & Setting</u> > <u>Folder</u> or Photos
Undo	Undo the last action
Undo All	Undo all the actions
Calibration	Use it to calibrate Arrim ONE to get better accuracy
Sub-Function	Will be introduced in detail in the specific function instruction
Introduction	Brief Introduction of current function
Current Function & Instruction	Current function mode, and tell you what to do in next action

Function & Setting Interface

