

Arrim ONE USER MANUAL (iOS)

Floor Plan

Creating Floor Plan with Arrim ONE is very simple. Select Floor Plan function in **Function & Setting**



Tap the Add Plan to create a new plan.



You can edit the name of the plan, and address.

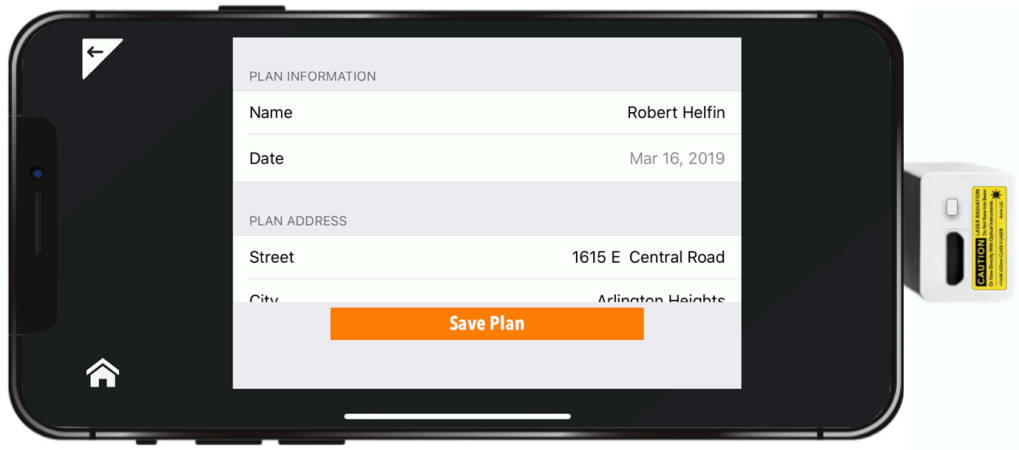
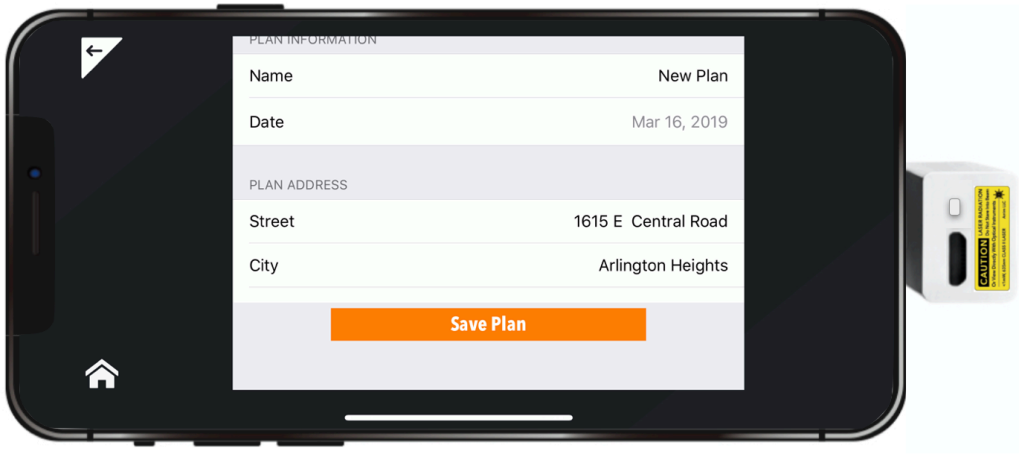

The Plan is created, and tap it to create rooms.



Tap Add Room to create a room floor plan



Select the floor and room type, and tap Start

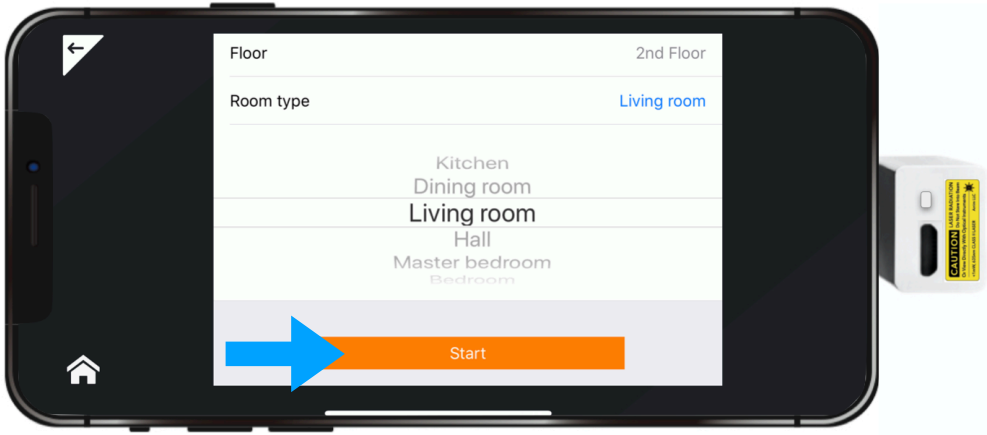
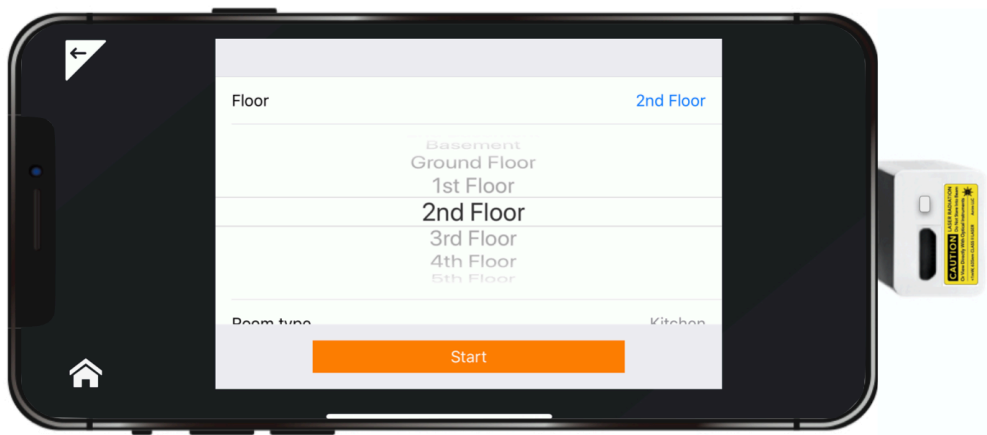
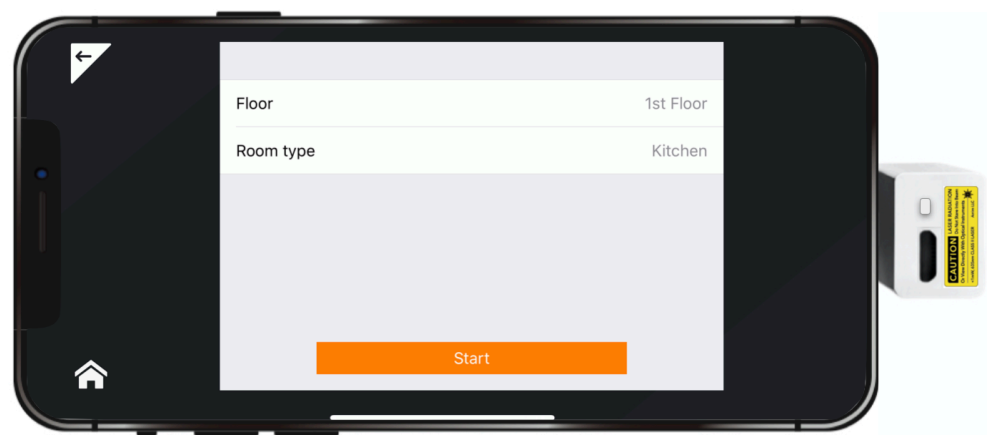

First, point the laser beam to the floor and hit **Measure** button



Point the laser to first corner and tap **Measure** button. If there is obstacle, you can move up the

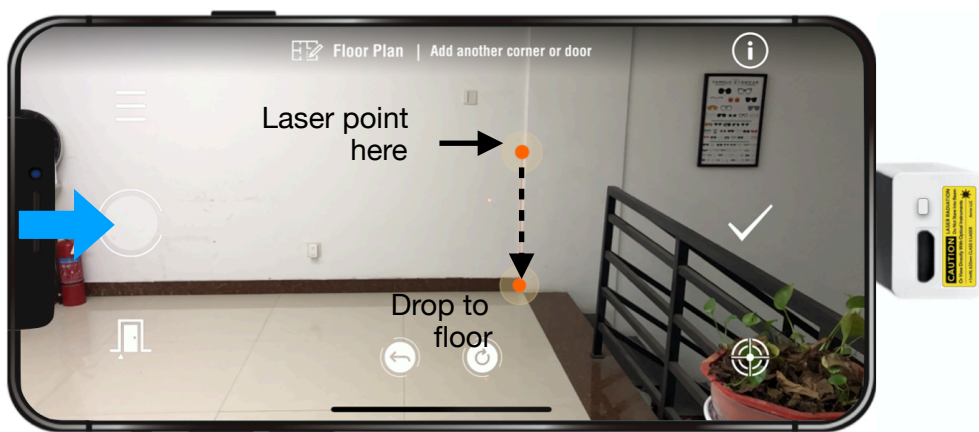

laser beam, and tap **Measure** , the point will automatically drop down to the floor.

Specify the corners one by one. And tap the **Door** button for door frame begins, and tap the **Door** button again for door frame ends. The virtual points for doors are blue.

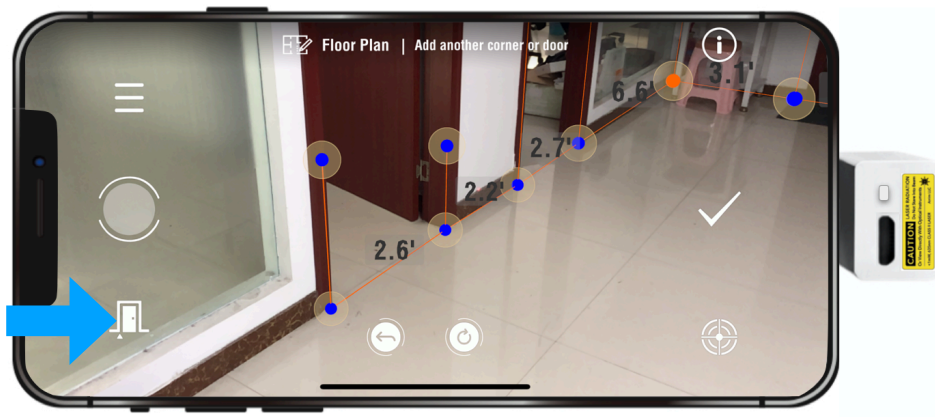

If you have specified all the corners and doors, click the **Check Mark** to generate the floor plan.

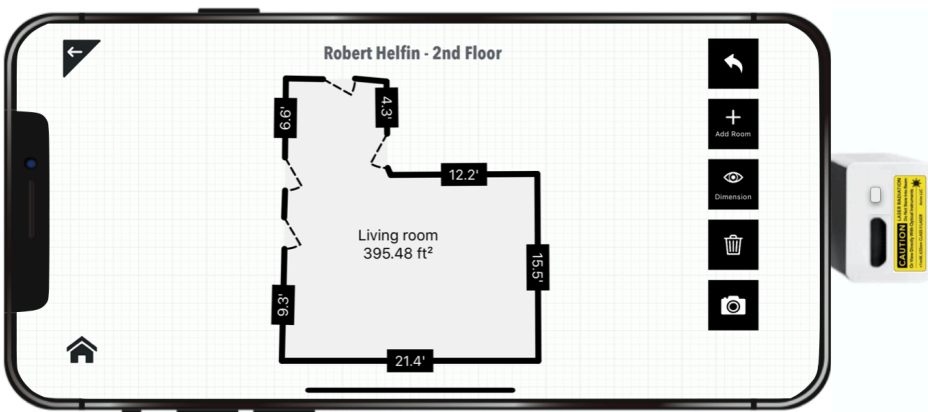
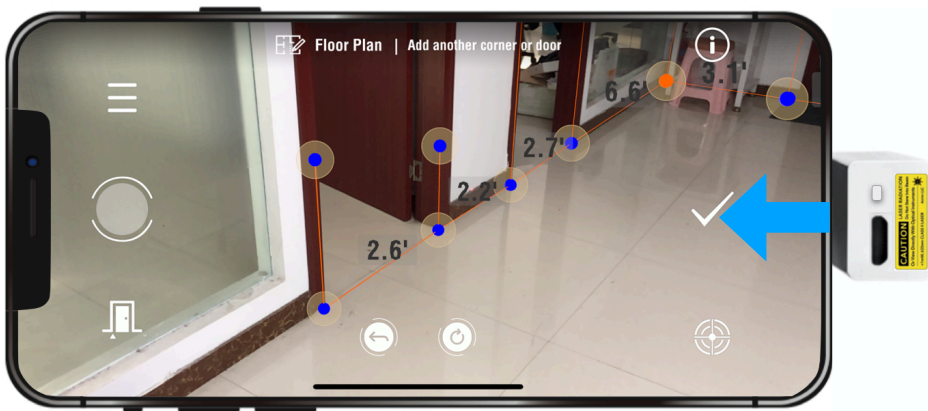

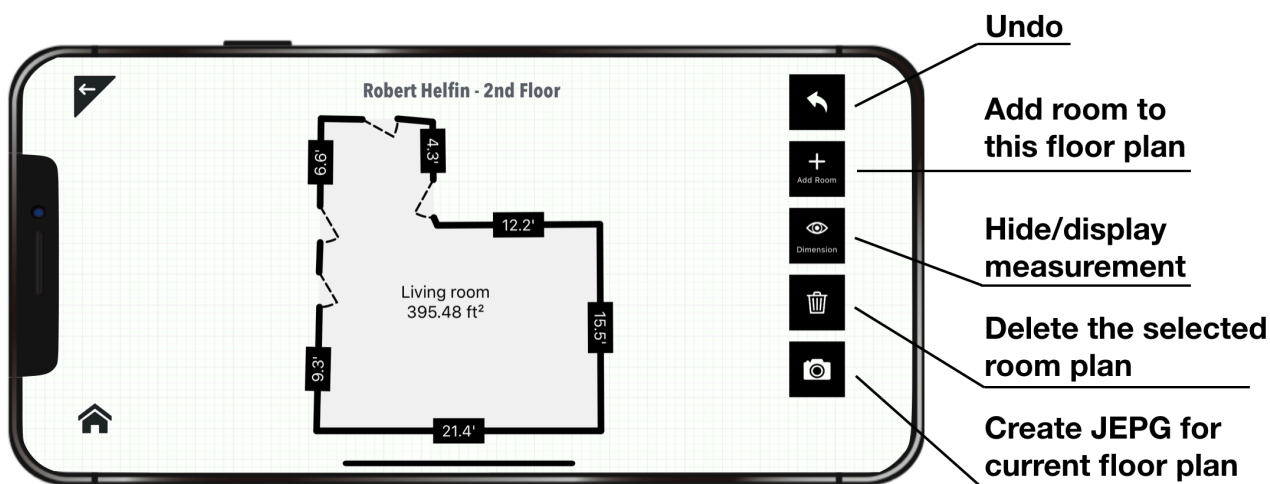

Tap the room to select. You can move it around, and rotate the plan.

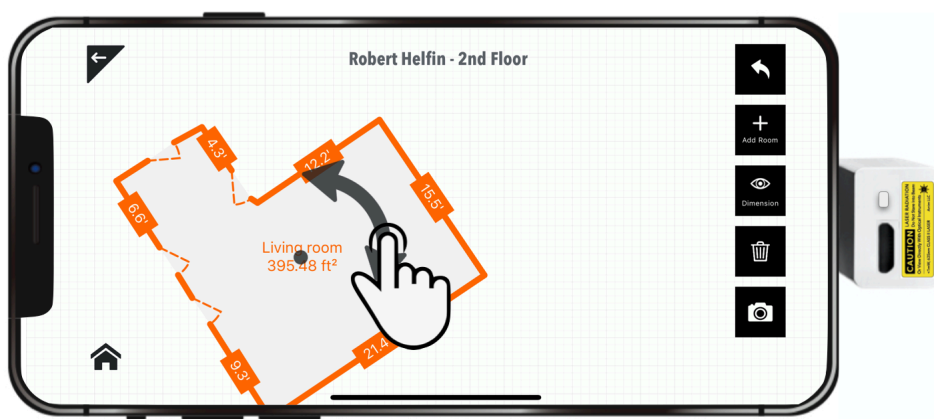

If you have multiple rooms, tap **Add Room** button, and start to create another room plan.

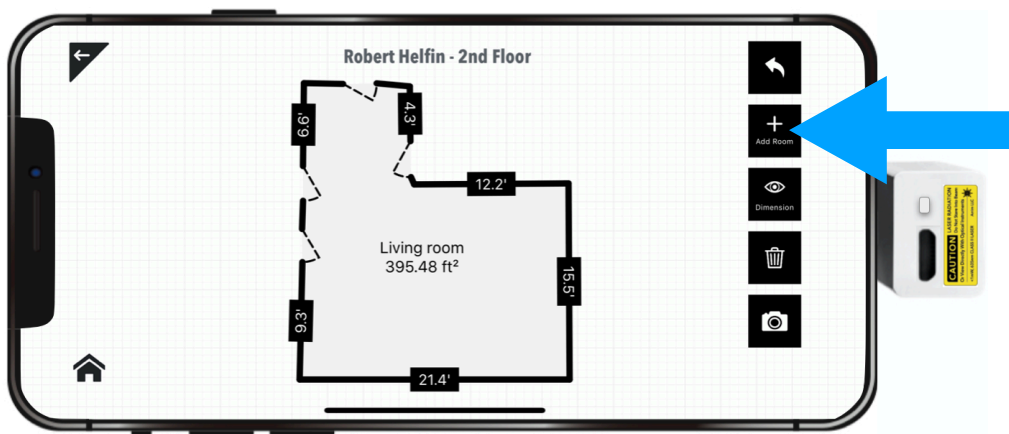

You can stitch multiple rooms together, and create the completed floor plan.

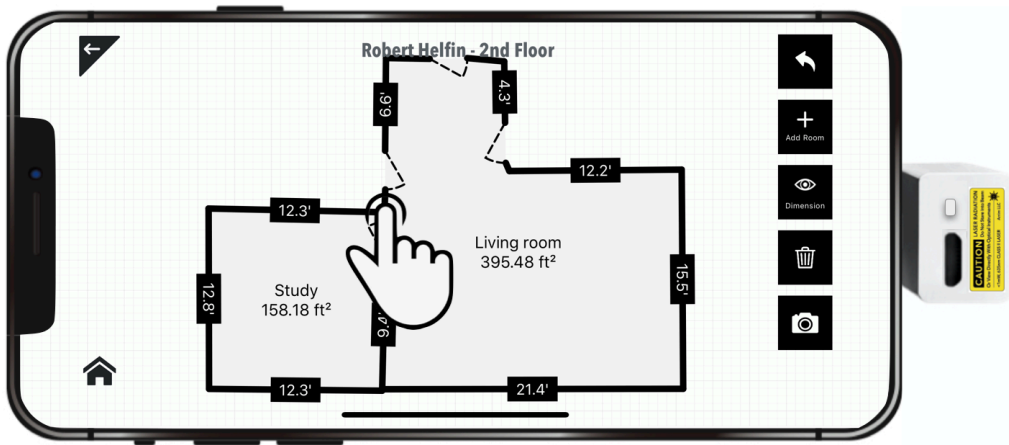

The floor can be exported to JPEG format, just click **Camera** button, and the JPEG picture will be saved in the **Folder**

